

USB charging socket C+C 45+20W

Technical specifications	
Input Voltage	10 - 30 Volt DC
Output voltage	5 Volt DC
Drivers Wattage	min. 75 Watt
Charging current	45 Watt + 25 Watt
Type	150 mm mains lead with tinned ends
Dimensions	55.5 x 55.5 x 40 mm
Built-in dimensions	Ø 46 x 32 mm
Housing colour	anthracite
Installation	screw fixing
Remarks	operation or charging of up to two USB devices with max. 45 Watt + 25 Watt, matching Berker Integro products delivery without cover frame

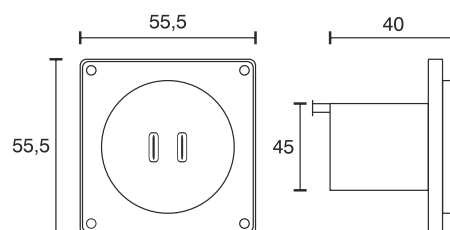

Article code

39.537.003